



COMPANY PROFILE

AN ISO 9001:2008 CERTIFIED COMPANY

rkcplcbe@gmail.com
www.rkcplcbe.com

THE COMPANY

Dear Sir / Madam,

Warmest regards and greetings from R. Karunanidhe, Managing Director of R Karunanidhe Constructions Pvt. Ltd., and a Civil Engineer with about 30 years of field experience.



With thirst to take up challenging opportunities, I have promoted this Company in 1996, with a vision to have Regular Clients & Repeating Orders.

With the strong back bone of efficient and enthusiastic Team Members comprising of Technical & Non-Technical Staff Members and dedicated labor force, we have served a large number of Clients in Tamil Nadu and neighboring States during these years.

Our strength lies in infrastructure which is entirely owned by us and perfectly maintained. Our infrastructure comprises fully automatic batching plants, concrete pumps, machineries, steel form work & scaffolding materials and fleet of vehicles. We take pride of being one of the reputed Contractors, better known for our no compromising policy on quality and finishing and completing the Projects on time. I am glad to present our profile with little more details in the following pages.

Sincerely,

R. Karunanidhe,
Managing Director,
R Karunanidhe Constructions Pvt. Ltd.,
Coimbatore.



Managing Director
R. Karunanidhe B.E, M.I.E

Director
R. K. Prabu B.E

Director
R. Chithra B.E

Types of work handled



Residential
Buildings



Textile Mills



Multi storey
apartments



Industrial
Buildings



Roller Flour
Mills



Institutions



Steel Structure
Works

The most promising MSME in
Coimbatore, Awarded by:



We are proud member of the following

- Ex-President, Coimbatore Builders and Contractors Association (CEBACA)
- Patron Member, Builders Association of India (BAI- Coimbatore)
- Member, Institute of Engineers, Chartered Engineers (India)
- Freemason, Engineers Lodge, Chennai
- Member, Coimbatore Civil Engineers Association
- Rotarian, Rotary Club of Midtown



ON GOING PROJECTS

M/s Roca Bathroom Products Private Limited

Location : Perundurai,Erode

Work value : 18 Crore

Type of work : Ware House

M/s Tatsavi Ethanol Unit II

Location : Tindivanam

Work value :30 Crore

Type of work : Grain based Distillery Unit

M/s VR water Private Limited

Location : Krishnagiri,Coimbatore

Work value : 15 Crore

Type of work : Pipe factory & Residential Building

M/s Precot Limited

Location : Hassan, Karnataka

Work value : 7 Crore

Type of work : Extention of Godown Building



M/s Kumaran Medical Center

Location : Coimbatore

Work value : 40 Crore

Type of work : Hospital Building



M/s Vummidi Bangaru Jewellers

Location : Coimbatore

Work value : 10 Crore

Type of work : Commercial Building





M/s Maashree Distilleries Private Limited

Location : Gulbarga

Work value : 32 Crore

Type of work : Grain based Distillery Unit



M/s Tatsavi Ethanol Unit I

Location : Tindivanam

Work value :30 Crore

Type of work : Grain based Distillery Unit





M/s OM mills

Location : Erode

Work value : 14 Crore

Type of work : Factory Building





M/s Praj Industries Limited

For Reliance Bio energy Limited

Location : Nellore

Work value : 26 Crore

Type of work : Compressed Biogas Plant



M/s. APA Hotels Pvt Ltd (Residency Towers)

Location :T Nagar, Chennai.

5 Basement floors(15 Meters) +
5 floors(30 Meters)

Top Down Construction method with
diaphragm Wall

Area - 1,00,000 Sft









M/s Jayabharath Homes Pvt Ltd

Location : Madurai

Work value :16 Crore

Type of work : Residential Apartment

M/s Kamadhenu Wires

Location : Idikarai, Coimbatore

Work Value : 8 Crore

Type of Work : factory Building

M/s RCCe Construct Pvt Ltd

Location : Chennai

Work Value : 7 Crore

Type of Work : Residential Apartment (Shell & Core)

COMPLETED PROJECTS

Bannari Amman Sugars Ltd

Modernization of distillery division

Work value : 25 Crores

Location : Periapuliyur & Sathy, Erode.





KPR Sugar And Apparels Ltd

Construction of 10000 TCD Sugar
factory unit 2

Work value : 48 Crores

Location : Gulbarga, Karnataka



KPR Sugar And Apparels Ltd

Construction of Ladies hostel for
Quantum knits

Work value : 30 Crores

Location : Chengapalli highway,
Tirupur



M/s KPR Institutions

Location : Arasur

Work value : 14 Crore

Type of work : Construction of Staff quarters

C.R.I. Pumps Private Limited

Location : Coimbatore

Work value : 12 Crore

Type of work : Modernization and expansion works



Infrastructure Works for
M/s. Barathidasan Institute of Management
at Trichy.

Hospital Building for
M/s. Balaji Nursing Home
at RS.Puram, Coimbatore.

Residential Building for
Mr. Natarajan Beemiah & Brothers
at RS.Puram (Opp. Annapoorna), Coimbatore.

KPR College of Arts, Science & Research

Location : Coimbatore

Work value : 25 Crore

Type of work : College Building





Bannari Amman Sugars Ltd

Location : Erode

Work value : 32 Crore

Type of work : Incineration Plant





Grain Based Distillery Unit for M/s. Nanda Devi Bio Energy LLP

Location :Tirunelveli.

Work value : 35 Crores

Area - 1,00,000 Sft







Town and City Developers

Location : Coimbatore

Work value : 30 Crore

Type of work : Residential Apartments



Jayabharath Homes Pvt Ltd

Location : Coimbatore

Work value : 8 Crore

Type of work : Residential Bungalows

Geethanjali Charity Foundation

Location : Vellore

Work value : 10 Crore

Type of work : Spring Days International School





Construction of Academic Block for
Kongu Public School
at Karumathampatti, Coimbatore.

R K Homes

Location : Coimbatore

Work value : 6 Crore

Type of work : Construction of Residential
Apartment





KPR Sugar and Apparels Ltd.

Location : Gulbarga, Karnataka.

Work value : 14 Crore

Type of work : Guest Houses & Family Residences





**Rajapalayam Mills Ltd
(Ramco Group Textile Division)**

Location : Rajapalayam.

Work value : 12 Crore

Type of work : Construction of
ETP (10,000 KL), STP and Boiler



J.R Mahal

Location : Mandya, Karnataka

Work value : 14 Crore

Type of work : Construction of
Conventional hall





MRC Mills Pvt Ltd

Location : Sipcot Cuddalore

Work value : 15 Crore

Type of work : Construction of Textile Processing Unit & ETP



Residential Bungalow
For Mr. Ganesh at Tirupur



Residential Bungalow

For Mr.Palanisami at Erode



Avaneetha Textiles Pvt Ltd

Location : Kaniyur, Coimbatore

Work value : 22 crores

Type of work : Spinning mill with Plant Rooms





Astrum Value Homes Pvt Ltd

Location : Mysore

Work value : 36 crore

Type of work : Construction of multistorey (11+2)
Apartment building

- Astrum Grand View



**RJDJ Properties For PAGE Industries Ltd
(Jockey India)**

Location : Mandya, Karnataka

Work value : 32 Crore

Type of work : Construction of Garment factory





Springdays School (CBSE)

Location : Chennai - Bangalore highway, Vellore

Work value : 30 Crore

Type of work : Construction of International school



Lavik Shanthi

Location : Anna Statue, Coimbatore

Work value : 12 Crore

Type of work : Multistory apartments (9+2)





Sree Sakthi Public Schools

Location : Coimbatore

Work value : 10 crore

Type of work : Construction of School Building



Sree Sakthi Engineering College

Location : Coimbatore

Work value : 15 crore

Type of work : Hostel building



Commercial Complex For Individual

Location : Avinashi road, Coimbatore

Work value : 8 crore

Type of work : Construction of commercial building





Chettinad Burgundy(Shell) by Chettinadu Cements

Location : Coimbatore

Work value : 12 Crore

Type of work : Multistorey apartments(7 + 2) & Club house



Sahuwala Flour Mills Pvt Ltd

Location : Banglore & Perundurai

Work value : 40 crore

Type of work : Atta plant with silos





RK Emerald

Location : Coimbatore

Work value : 5 crore

Type of work : Residential apartments



Nithya Estates & Developers India Pvt Ltd

Location : Coimbatore

Work value : 15 Crore

Type of work : Residential apartments



Vidya Vikas Institutions (Trichengode Group)

Location : Tanjore & Coimbatore

Work value : 40 Crore

Type of work : Academic Blocks, Hostel Blocks, Ancillary



**Vidya Vikas Institutions
(Coimbatore)**



Krishna Warehouse

Location : Trichy

Work value : 6 crore

Type of work : Construction of Warehouse for reliance





Lakshmi Automatic Looms (Lakshmi Mills Group)

Location : Hosur

Work value : 4 crore

Type of work : Construction of warehouse



Park College Of Engineering & Technology

Location : Kaniyur, Coimbatore

Work value : 30 crore

Type of work : Construction of Academic & Hostel Blocks



Ammarun Enviroguard Pvt Ltd

Location : Kariampalayam, Annur

Type of work : Foundry buildings & Other utility blocks



Nanjappa Polytechnic

Location : Karumathampatti, Coimbatore

Type of work : Academic blocks



Tejaa Shakthi Institute Of Technology (For women)

Location : Karumathampatti, Coimbatore

Type of work : Administration, Academic & Hostel blocks



Tamilnadu College Of Engineering

Location : Karumathampatti, Coimbatore

Work value : 20 Crore

Type of work : Academic, Hostel & auditorium blocks





V.S.B Engineering College

Location : Coimbatore

Work value : 20 Crore

Type of work : Academic, quarters & Hostel buildings



V.S.B Engineering College

Location : Karur

Work value : 18 Crore

Type of work : Academic, quarters & Hostel buildings



Globus Realtors Pvt Ltd

Location : Coimbatore

Work area: 10 Crore

Type of work : Construction of globus windermere apartments at racecourse and conventional hall at sathy road





Town & City Developers (KG Group)

Location : Coimbatore

Work value : 20 Crore

Type of work : Construction of Residential
ApartmentConventional hall

Precot Merdian Ltd

Location : KIDBA SEZ Zone, Hassan, Karnataka
Value : 20 Crore
Type of work : Factory building and other utility blocks

M/s. Precot Ltd.

Location : Coimbatore.
Value : 6 Crore
Type of work : Modernization and Expansion

Bannari Amman Sugars Ltd

Location : Tiruvannamalai & Thirukovilur
Work value : 30 crore
Type of work : Staff quarters, Sugar godowns & Other utility blocks

Bannari Amman Flour Mills Ltd

Location : Pothanur & Perundurai
Work value : 8 crore
Type of work : Staff quarters, Sugar godowns & Other utility blocks

Avinashilingam University

Location : Coimbatore
Type of work : Expansion of academic blocks

Rajshree Sugars And Chemical Pvt Ltd

Location : Villupuram
Type of work : Construction of sugar godown

SRF Ltd

Location : Trichy
Type of work : Expansion of industrial building

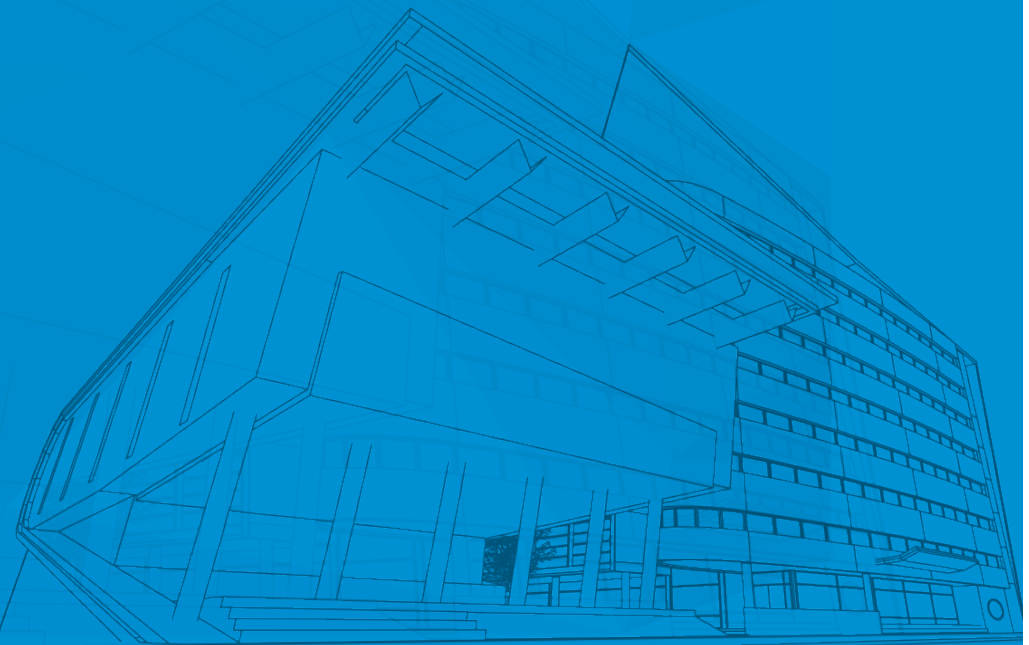

Shiva Tex Yarn Unit - II

Location : Karumathampatti, Coimbatore
Type of work : Construction of Warehouse

Premier Mills Group

Location : sipcot(perundurai), Coimbatore
Type of work : Expansion of spinning department and staff quarters

Kumar Spinning mills

Location : Thirunelveli
Type of work : Expansion of spinning Shed

Moon Spinners Pvt Ltd

Location : Nanguneri, Thirunelveli district
Type of work : Spinning shed with humidification plant & office building

Tamilnadu Water Supply And Drainage Board

Location : Coimbatore
Type of work : Construction of RCC overhead tanks and pipelines

Frontier Knitters

Location : Tirupur
Type of work : Construction of Administrative blocks

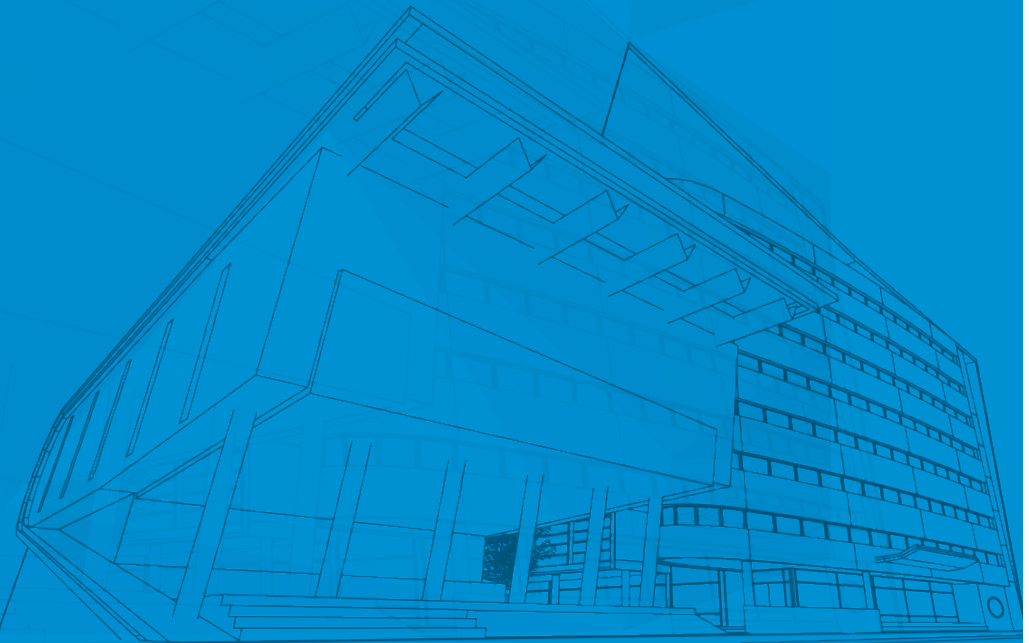

Dhanalakshmi Paper Mills Pvt Ltd

Location : Nilakottai
Type of work : Construction of raw material godown

Shree Ganesh Minerals

Location : Chettipalayam, coimbatore
Type of work : Construction of factory building

Seyadu Beedi Company

Location : Trichy & Thisyanavillai
Type of work : Construction of stock godowns, office and guest houses

Ramakrishna Mills Ltd

Location : Sathyamangalam
Type of work : Construction of yarn conditioning plant

Gomathi Spinner

Location : Chittoor, AP
Type of work : Expansion of preparatory and spinning shed

Suzlon Rotor International Ltd

Location : Karumathampatti, Coimbatore
Type of work : Temporary project office

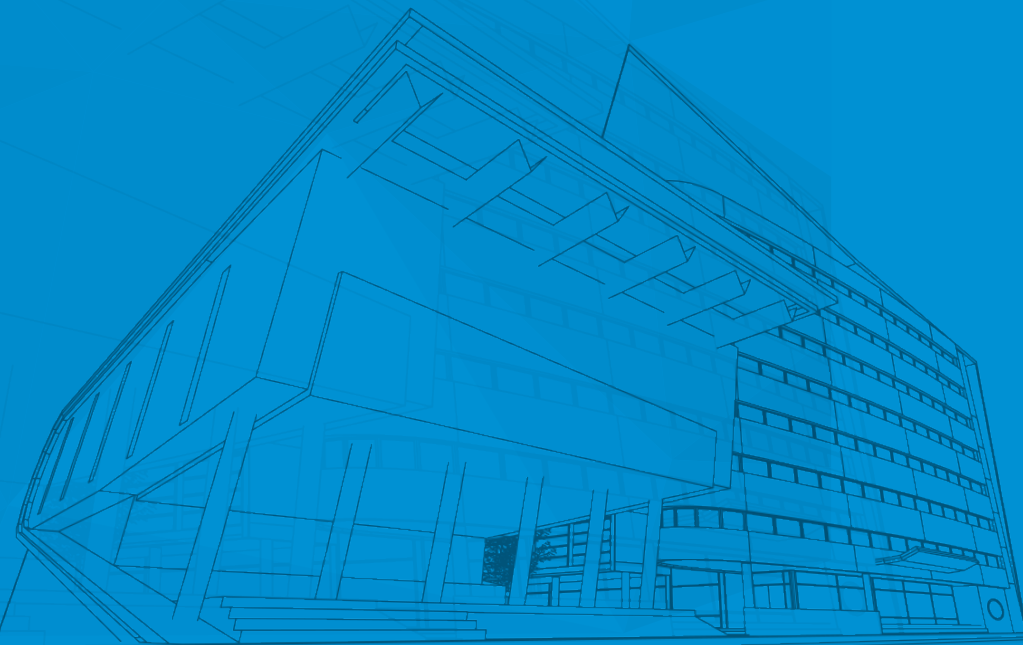

Dev Apartments

Location : Ashok nagar & Tiruvanmaiur, Chennai
Type of work : Construction of residential apartments (60 flats as turnkey projects)

Seyadu Cotton Mills

Location : Tirunelveli
Type of work : Construction of spinning shed with humidification plant

Sara R & D Ltd

Location : Thamarai kulam, pollachi
Type of work : Construction of industrial buildings

Elgi Equipments Ltd

Location : Singanallur
Type of work : Expansion of railway compressor building, Telco & ROCD building, DG shed expansion

S. P. Apparels Ltd

Location : Sathyamangalam & Salem
Work value : 15 Crore
Type of work : Construction of garment factories

Elgi Electric & Industries Ltd

Location : Thekkalur, Coimbatore
Type of work : Construction of garment factory, Staff quarters

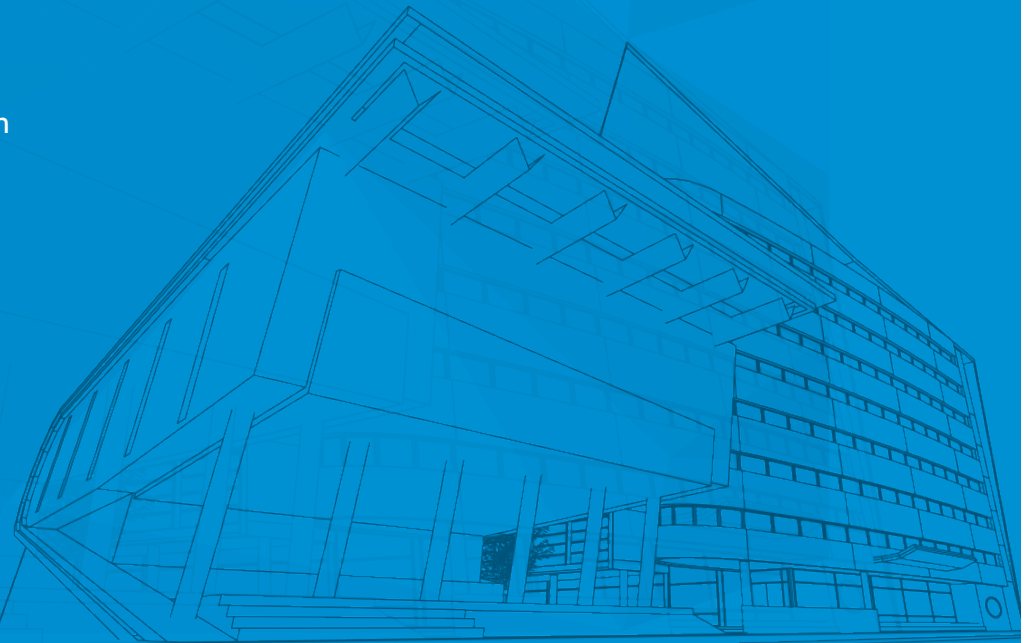

M/s Sri Ranganathar Valves (P) Ltd

Location: Thennampalayam, Coimbatore
Type of work : Expand of factory buildings

M/s. Unicorn Valves Private Limited

Location: Nachipalayam (Madukkarai, Coimbatore)
Type of work: Construction of factory buildings.

M/s. Anamalais Motors (P) Ltd.

Location: Renault showroom , Nava india, Coimbatore
Type of work: Expansion of show room building

M/s. Elgi group of companies & Super Spinning Mills Ltd.

Location: Thekkalur, Coimbatore
Type of work : Construction of garments factory

Location: karur
Type of work : Expansion of spinning & preparatory shed,cotton godowns

Location: Pallapalayam, Coimbatore
Type of work : Construction of production building for sara elgi upvc windows

Location: A unit, Hindupur, Andhra pradesh
Type of work: Construction of staff quarters

Location: Super sara unit, Hindupur, Andhra pradesh

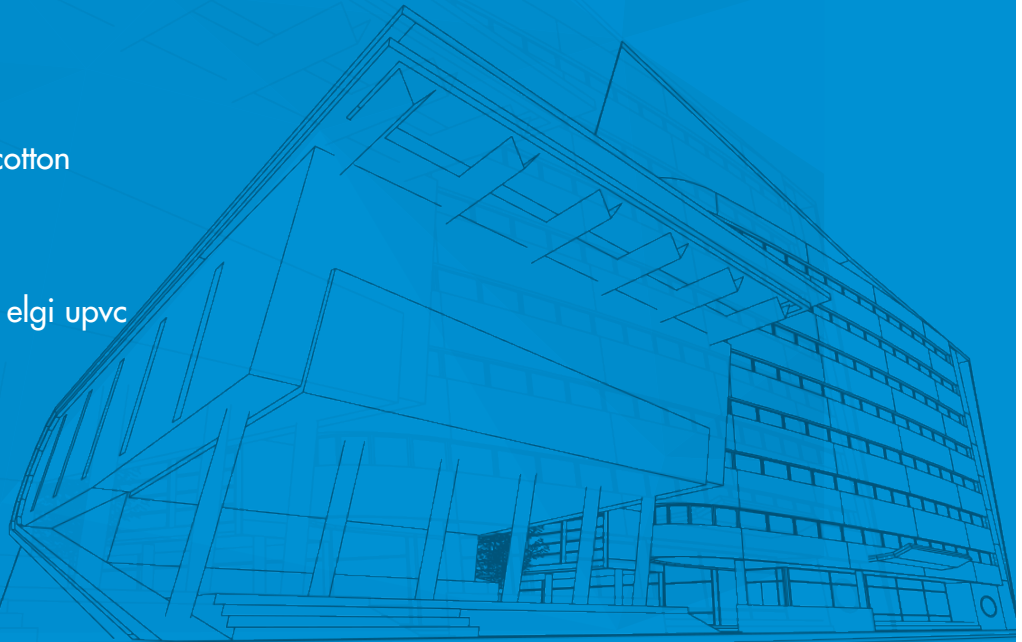

M/s. Sakthi Murugan Group

Location: Avinashi, Coimbatore
Type of work: Expansion of roller flour mill

M/s. Young Brand Apparel (P) Ltd.

Location: Sengalpattu
Type of work: Expansion of roller flour mill

M/s. Precot Meridian Limited

Location: Perundurai, Sethumadai & Walyar
Type of work : Construction of dormitory block, expansion of spinning dept.

M/s. Sree Rajeshwari Mills Limited

Location: B Unit, Karaikal
Type of work : Expansion & modification of production building

M/s. Ndr Warehousing (P) Ltd

Location: Ettimadai, Coimbatore
Type of work : Construction of warehouse building

M/s. Murugan Textiles

Location: Palladam
Type of work: Construction of spinning mill & other utility blocks

M/s. Kovai Medical Center & Hospital

Location: Coimbatore
Type of work: Construction of Primary Health Center

M/s. Chamundeswari Sugars Ltd.,

Location: Hassan, Karnataka
Work Value: 15 Crore
Type of work: Construction of Co-gen Plant

M/s. KPR Mill Limited

Location: Karumathampatti, Coimbatore
Work Value: 12 Crore
Type of work : Expansion of spinning mill.

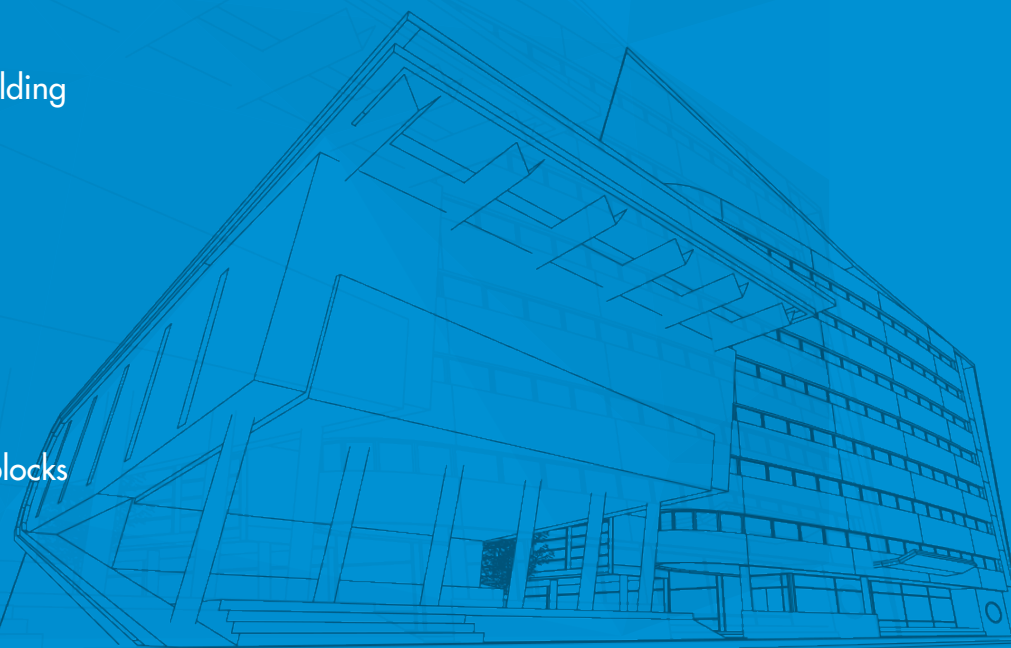

EMPLOYEES



TECHNICAL

B.E Holders 31 No's
Diploma Holders 16 No's



NON- TECHNICAL

Exp. Foreman 10 No's
Exp. Site supervisor 25 No's
Office Staff 15 No's
Driver 10 No's



WORKERS

Skilled Mason	350 No's	Plumbers	25 No's
Skilled carpenters & Barbenders	250 No's	Electrician	15 No's
Unskilled Labours	600 No's	Fabricators	15 No's
Painters	50 No's		

LIST OF VEHICLES

Bharat Benz (2523) Tipper..... 1 No's
Ashok Leyland (Truck) 2 No's
Ashok Leyland (Tipper 1616) 7 No's
Eicher 1090 (10 Ton Capacity)..... 1 No's
Tractors fitted with loader and for
inter carting (Mahindra) 6 No's

JCB 2 No's
Cars 6 No's
Force Jeep 2 No's
Two wheeler for site use 20 No's
Pickup van 2 No's







CENTRAL STORES



DESCRIPTION:	QTY
Schwing Stetter M30Z batching plant- MCI 70 control panel	2 no
Schwing Stetter - concrete boom pump - S36X	2 nos
Schwing stetter transit mixer - 8cum.	6 nos.
Mobile tower crane	1 no
SCHWING STETTER CP18 Plant MCI 55 / universal 15 cum per hr	3 set
SCHWING STETTER Silo 100 MT Capacity with Blower	2 Nos
SCHWING STETTER CONCRETE PUMP (350 & SP 1400)	2 Nos
JCB / CAT Back hoe Loader	2 Nos
VPG & COSMOS make 10/12 cum/hour type Concrete Batching Plants	3 Nos
Hydraulic Operated Dumper Two Ton Capacity	3 Nos
Full Load Hydraulic Hopper & Half Loaded Concrete Mixer Machine (Diesel & Electric)	20 Nos
Roller Compactor (6 Tonne)	1 No
Petrol & Electric Vibrators with 60, 40, 20mm Needles	45 Set
Mechanical / Electrical Earth Rammer (1 Ton Capacity)	5 Nos
Builder Hoist — Electrical Operated (250 Kg Capacity)	5 Nos
Builder Hoist — Electrical Operated (1 MT Capacity)	11 Nos
3' x 2' & 4' x 2' Centering Sheets, Acro Span, Adjustable sheets,	
Adjustable Telescopic Steel Props for form-work	4,00,000 Sft
1 to 3 HP Motors for Curing, Dewatering Electrical Pump	
(Sludge Pump) & Diesel Engine	25 Nos
Leveling Instrument & Electronic Theodolite	6 Nos
Steel & Plywood Column Boxes	110 Set
Compression Testing Machine	5 Nos
Welding, Drilling & Gas cutting Tools	6 Set
Generator - 7.5KVA to 62.5 KVA	11 Nos
Scaffolding Unit—APS & Cup-lock system	1,50,000 Sft

QUALITY ASSURANCE POLICY

The following tools will be maintained at site to ensure quality of materials and works:

- o Jar test will be conducted to find sand bulkage and slit content.
- o The Slump cone test will be conducted to ensure consistency and workability.
- o MS boxes for measuring ingredients of concrete works.
- o MS cubes will be maintained at site to take test specimens of concrete works.
- o Line and level will be maintained by suitable means.
- o Pour Clearance will be obtained from Client's Engineer for roof concrete works.
- o Mechanical compactor will be used in basement filling.
- o Site installed mixer machine will be used for all concrete works.
- o Needle vibrators will be used for proper compaction of RCC works.
- o Good quality formwork along with adequate supports will be used.
- o Readymade cover blocks of suitable thickness will be used in RCC works.
- o Adequate curing will be carried out with mechanical pumps and hose.
- o Periodic cube tests will be conducted and recorded.
- o Plumbing and water supply lines will be tested for leakage before concealing.
- o Painting works will be carried to give uniform finish after surface preparation.

INFORMATION TO THE WORKERS

The workers and their safety representative shall be informed of all measures that shall be taken with regard to their safety on construction sites. This information shall be understandable by the workers.

Before the start of construction work, the safety representative, and senior safety representative if one has been appointed, shall be informed of the plan for safety, health and working environment.

SAFETY AND ENVIRONMENTAL POLICY

When executing a project, special attention shall be paid to the following considerations:

- a) Ensuring good order and fully satisfactory conditions of cleanliness at the construction site,
- b) Placement of work stations with regard to access and roads or areas for passage or movement,
- c) Conditions under which various materials are handled,
- d) Maintenance, pre-commissioning checks, and checks on installations and equipment with a view to correction of faults that may affect the workers' safety, health and working environment,
- e) Demarcation and laying out of areas for storage and conservation of various materials, particularly hazardous materials or substances,
- f) Conditions regarding removal of hazardous materials used,
- g) Storage and disposal or removal of waste and scrap,
- h) Adaptation, on the basis of progress made, of the actual period to be allocated for the various types of work or stages of work,
 - i) Cooperation between employers and employed persons, and
 - j) Coordination of the project with other activities on or in the vicinity of the construction site,
- k) Proper usage of safety equipments and tools, maintaining safety sign boards at work sites. The obligations of employers and employed persons

In order to preserve safety, health and working environment on the construction site, employers and self-employed persons shall:

- a) Take necessary measures to comply with all relevant statutes and regulations
- b) Take into account directions from the coordinator(s) for safety, health and working environment matters.



32/33, Valluvar Street,
Sivananda Colony,
Coimbatore - 641012



0422 - 2495011
0422 - 2493111
98422 47911



rkcplcbe@gmail.com
www.rkcplcbe.com